

**NOTES:**

1. Material : Music Wire
2. Finish : Glod Irridite
3. Ends : Closed and Ground
4. Total Coils : 10.000
5. Sugg. Max. Deflection : 2.800 (in)
6. Sugg. Max. Load : 2.300 (lbs)
7. All Drawing Dimensions are in Inches [mm]

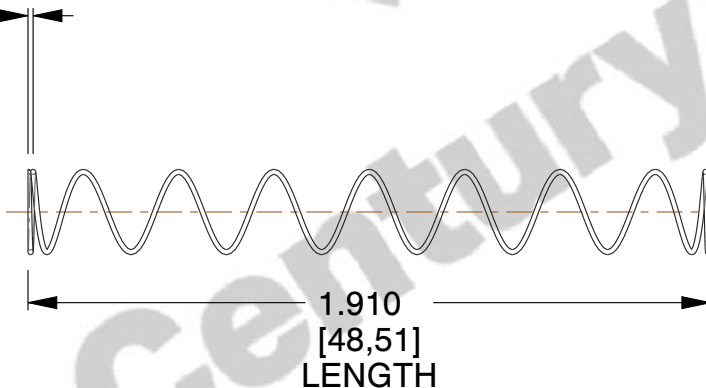

Ø 0.030  
[0,76]  
WIRE DIA



GROUND  
SURFACE

Ø 0.500  
[12,70]  
O.D

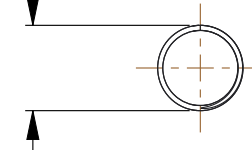

COMPONENT	SPRINGS
11772  COMPRESSION SPRINGS	UNIT
	INCH [mm]
	SHEET
	1 of 1