

**NOTES:**

1. Material : Spring Steel
2. Finish : Glod Irridite
3. Ends : Closed
4. Total Coils : 10.000
5. Sugg. Max. Deflection : 0.110 (in)
6. Sugg. Max. Load : 2.300 (lbs)
7. All Drawing Dimensions are in Inches [mm]

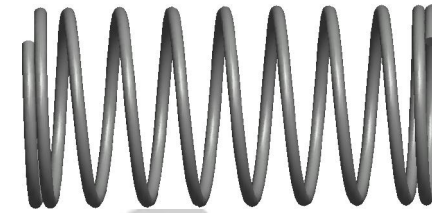

Ø 0.030  
[0,76]  
WIRE DIA

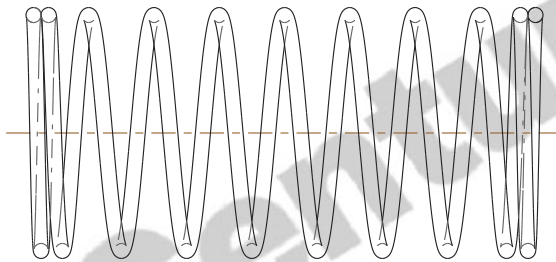

1.910  
[48,51]  
LENGTH

Ø 0.500  
[12,70]  
O.D

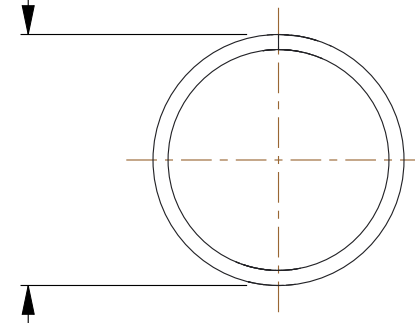

| COMPONENT                    |  | SPRINGS   |        |
|------------------------------|--|-----------|--------|
| 11772<br>COMPRESSION SPRINGS |  | UNIT      |        |
|                              |  | INCH [mm] |        |
|                              |  | SHEET     | 1 of 1 |